



KONICA MINOLTA

Giving Shape to Ideas

INTUITIVE USER INTERFACE FUNCTION RICH MONO & COLOR



-
-
-
-
-
-
-
-
-
-
-
-
-
-
-
-
-
-

Simitri
with Biomass

A3 Colour Multifunctional Printer
bizhub c226

Brighten the future with bizhub C226. Discover the advantages of colour document production up to A3 size and enjoy a vibrant new edge.



Full Colour up-to A3 Size

Boost document impact with full-colour output up to A3 size. Documents look more professional when produced in full colour at larger dimensions. It's a sure way to satisfy clients and broaden business horizons.

High Quality and Speed

Images are beautiful and text is exceptionally clear thanks to 600 DPI output with separate processing of images and text to optimise every pixel. This class-above quality is delivered at 22 PPM for printing and copying (30 OPM for scanning)

Intuitive Multi-Touch Screen

Operation is simplified by a user-friendly 7 inches multi-touch screen with intuitive user interface and touch gesture operation. It supports mobile connectivity as well, so users can enjoy flexible work styles and higher productivity.



Multi-Touch Screen

The 7 inches Multi-Touch Screen presents information with clarity in an intuitive user interface that help everyone to navigate.

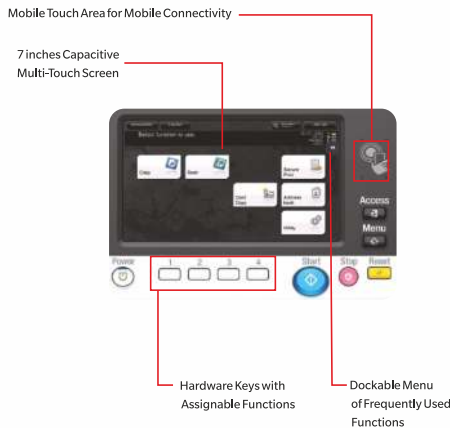

Widgets

Administrators can easily convey messages to bizhub users by posting text, icons and GIF animations on the touch screen. These widgets are convenient for sharing information about bizhub operation, placing ads for Print-for-Pay customers or improving office communications.

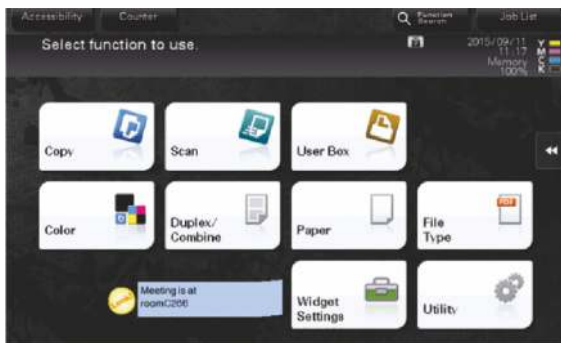

ID Copy

This feature makes it easy to print the front and back of an ID card on the top and bottom of a single page in one pass. For easy access, place an ID Copy shortcut button on the top menu.



Touch Gesture Operation

The same touch gestures used on mobile devices can be used on the touch screen to simplify operation. Tap to select, double tap to activate, flick to scroll, pinch to magnify and more.



Scan Preview

Scanned paper documents can be previewed on the touch screen before saving or sending. Just flick to scroll through pages, rotate them when desired and delete unnecessary pages until satisfied. Then save or send.



INFO-Palette

Whether users operate bizhub C226 from its intuitive touch panel, a connected PC or mobile device, the same intuitive user interface is shared to make operation a breeze.



Mobile Connectivity

Enjoy a flexible mobile work style by using iOS, Android and Windows 10 mobile devices to take advantage of printing and other features.



Mobile Printing

Use the latest mobile technologies to connect with bizhub C226, print documents, import scanned data and more from smartphones and tablets.

	iOS	Android	Windows 10 Mobile
AirPrint	○	—	—
PageScope Mobile	○	○	○
Mopria Print Service	—	○	—
Konica Minolta Print Service	—	○	—

Wireless LAN*

Wi-Fi Direct allows computers and mobile devices in your office to wirelessly connect with bizhub C226. This creates a fully independent network that supports BYOD (bring your own device) without additional investment. If your office already uses a wireless corporate LAN, bizhub C226 can easily connect with it instead to offer advantages to everyone in the office.

*Optional upgrade Kit UK-215 is required. Local Interface Kit EK-608 or EK-609 is also required.



Connect With Android Devices

The bizhub C226 has a Mobile Touch Area on the operation panel with embedded NFC (Near Field Communication) technology ensures smooth, quick connections through which you can pair Android mobile devices with bizhub C226 by simply holding them close to the Mobile Touch Area. This can also be used to login, print files, scan documents and import scanned data.

Connect with iOS devices

iOS devices pair using Bluetooth LE (BLE)*3 technology. Once paired, they can log in to bizhub C226, print*2 files via PageScope Mobile, receive scanned*2 documents and more.

*1 Android OS 4.4 or higher and PageScope Mobile must be installed.

*2 Initial setup required for logging in. Wireless LAN environment required for printing and scanning.

*3 Optional Device Connection I/F Kit EK-609 is required.



Streamlined Workflow

Smart technology simplifies once-complex operations to streamline document production and save time.

Hardcopy Digitisation

Scanned hardcopies can be saved as a PDF, compact PDF or editable PowerPoint file*. The files are small with excellent image quality and can be saved in internal memory or mobile devices.



Stamp Function

Paper documents can be copied with stamps, watermarks, page numbers, headers, footers and other images. These are digitally added to any part of the page without modifying the original document.



Banner Print

Create appealing promotional materials in-house on bizhub C226 through the Banner Print feature that enables you to print on long paper (up-to 1,200 mm) from by pass tray.



Multiple Carbon Copies

In a single operation, users can produce multiple sets of copies containing an "original" from one paper source and "carbon copies" from other paper sources. It is the quick and easy way to create carbon copies.

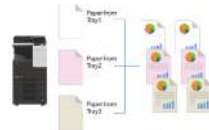

Repeat Function

When copying small items like labels and tickets, save paper by having multiple images of that item printed in a single sheet of paper in one pass.

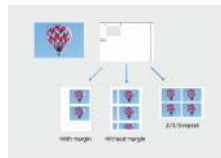

Make a Positive Impression

Communicate effectively by producing vibrant full-colour documents up to A3 size that inspires.

Full Colour Up-To A3 Size

Make your business look its best with bigger, more beautiful documents that create a lasting impression by printing, copying or scanning for full colour documents up-to A3 size.



High Quality Output

Compare the differences between conventional 600 DPI output and documents produced by bizhub C226. Colours are more natural, gradients are smoother and text is easier to read due to special processing that separately optimises images and text.

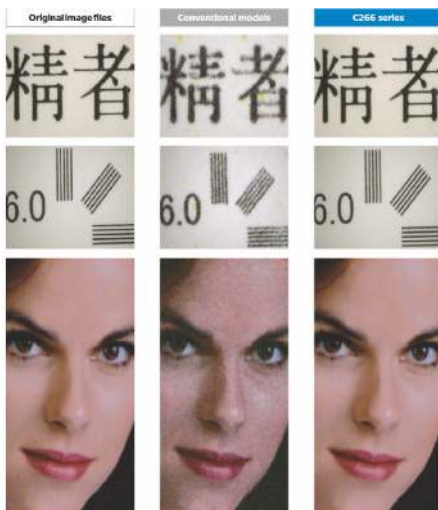

Solid Security

Convenient security features simplify the initial security setup and help prevent unauthorised access in the way that best meets your company's needs.

Easy Authentication

Smooth and efficient authentication* by means of password, IC card and biometric (finger vein) options are supported. Authentication can be handled via external device and login can be performed at the same time.

*Local Interface Kit EK-608 or EK-609 is required.

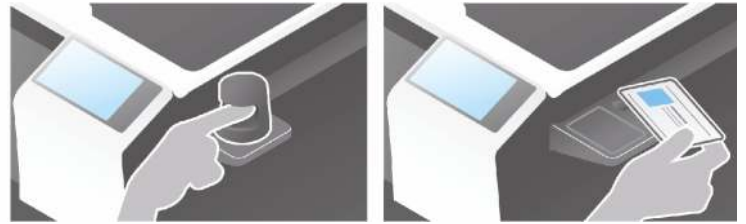

Quick Security Set-Up

The initial security set-up is simplified by a "Quick Security" shortcut key on the main menu which provides quick access to the most vital security settings (administrator password, password rules, IP filtering, PageScope Web Connection settings and security warning displays).



Minimal Environmental Impact

bizhub C226 embodies Konica Minolta's commitment to minimising environmental impact through energy efficiency and recycling.

Low Power Consumption

The bizhub C226 is highly energy efficient as it consumes only 0.5W in sleep mode. It also minimises energy use during normal operation to easily exceed the latest Energy Star TEC standards. This helps reduce both CO₂ emissions and TCO.



Note: TEC values applied to the International Energy Star Program Version 2.0 (100-watt specification).



Power Saving Modes

Simply press and hold the power key to access four power saving modes (Sub Power Off, Low Power Mode, Sleep Mode and ErP Auto Power Off). These modes were previously accessed through separate keys.

Eco Shortcuts

Encourage the use of eco-friendly features by placing shortcuts to them on the top menu. Eco Copy lowers toner and paper costs. Eco Settings lowers power consumption and Eco Info provides a summary of recent eco-friendly operations.

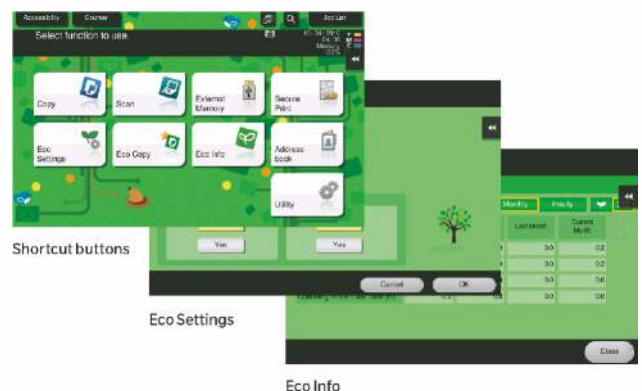

Sleep Mode

bizhub C226 automatically switches to sleep mode after a user-defined period of inactivity. This mode reduces power consumption to a mere 0.5W by cutting off power to the CPU. When users want to use bizhub C226 again, it switches back to full power in seconds.

Printer Specifications

Print Resolution	1,800 (equivalent) x 600 DPI
Page Description Language	PCL 6 (XL Version 3.0) Emulation, PCL 5e/c, PostScript 3 (3016) Emulation, XPS
Operating Systems	Windows Vista (32/64), Windows 7 (32/64), Windows 8.1 (32/64), Windows 10 (32/64), Windows Server 2008 (32/64), Windows Server 2008 R2, Windows Server 2012, Windows Server 2012 R2, Macintosh OS X 10.6 or Later, Linux
Printer Fonts	80 PCL, 137 PostScript 3 Emulation
Mobile Printing	AirPrint (iOS), Mopria (Android), Wi-Fi Direct (optional), Konica Minolta Print Service (Android), PageScope Mobile (iOS, Android, Windows 10 Mobile)

Scanner Specifications

Scan Speed	Up to 30 OPM
Resolution	Max.: 600 x 600 DPI
Scan Modes	Scan to Email, Scan to PC (SMB), Scan to FTP, Scan to WebDAV, Scan to WSD (Web Service), Scan to DPWS (Device Profile for Web Service), Network TWAIN scan
File Formats	JPEG, TIFF, PDF, Compact PDF, XPS, Compact XPS, PPTX
Destinations	1,300 (single + group), LDAP Support

Copier Specifications

Copying Process	Electrostatic Laser Copy, Tandem, Intermediate
Toner System	Simitri® HD Polymerized Toner
Copy/Print Speed A4	Up-to 22 PPM
Copy/print Speed A3	Up-to 14 PPM
1 st Copy Out Time	8.4 sec. Color / 6.8 sec. Mono
Warm-Up time ¹²	Approx. 20 sec.
Copy Resolution	600 x 600 DPI
Gradation	256 Gradations
Multicopy	1-9,999
Original Format	A5-A3 or 11 x 17
Magnification	25-400% in 0.1% Steps, Auto-zooming

¹² Warm-up time may vary depending on the operating environment and usage

System Overview

System Memory	Standard 1 GB and Max 3 GB* *With optional 2 GB memory UK 211
Interface	10-BASE-T/100-BASE-TX/1,000-BASE-T Ethernet, USB 2.0 Wi-Fi 802.11a/b/g/n/ac (optional)
Network Protocols	TCP/IP (IPv4/IPv6), FTP, SMB, SMTP, WebDAV
Frame Types	Ethernet 802.2, Ethernet 802.3, Ethernet II, Ethernet SNAP
Automatic Document Feeder DF-630 (optional)	Up-to 70 Originals, A5-A3, 35-128 GSM
Paper Size	A5-A3, Customised Paper Sizes (width: 90 - 270 mm, Length: 139.7 mm - 431.8 mm), Banner Paper Max. 1,200 x 297 mm
Printable Paper Weight	60-256 GSM
Paper Input Capacity	Standard: 1,150 Sheets Max.: 3,600 Sheets
Tray 1	500 Sheets, B5-B4, 60-256 GSM
Tray 2	500 Sheets, B5-A3, 60-256 GSM
Tray 3 PC-114 (optional)	1 x 500 Sheets, B5-A3, 60-256 GSM
Tray 4 PC-214 (optional)	2 x 500 Sheets, B5-A3, 60-256 GSM
Paper Feed Cabinet PC-414 (optional)	2,500 Sheets, A4, 60-256 gsm
Bypass Tray	100 Sheets, A5-A3, Custom Sizes (width: 90-270 mm, Length: 139.7 mm - 1,200 mm), Banner 210 x 1,200 mm, 127-210 gsm
Automatic Duplexing	A5-A3, 50-128 GSM
Power Consumption	[220-240 V, 50/60 Hz] Less Than 1.58 kW (system)
System Dimensions (W x D x H)	571 x 660 x 785.5 mm (excl. ADF and lower paper tray unit) 22.5 x 26.0 x 30.9 inch (excl. ADF and lower paper tray unit)
System Weight	Approx. 71 kg (156.5 lb)

Components and Options

DK-514 Copier Desk	Provides storage space for print media and other materials
DF-630 Document Feeder	Reversing automatic document feeder, capacity 70 originals
OC-513 Original Cover	Cover instead of ADF
HT-509 Dehumidification Heater	Dehumidification heater for Paper Feed Cabinet, for PC-114/214/414, DK-514
MK-734 Dehumidification Heater Power Supply Box	Dehumidification Heater Power Supply Box (Cabinet heater), for PC-114/214/414, DK-514
KP-101 10-Keypad	10-Key
AH-101 Assist Handle	Assist Handle
UK-215 Wireless LAN Kit	Wireless LAN and Wireless LAN Access Point Mode
EK-608 USB I/F Kit	USB Hub Kit
EK-609 USB I/F Kit	USB Hub Kit, Bluetooth LE
MK-735 Mount Kit	Installation Kit For ID Card Reader
AU-201S ID Card Authentication	IC Card Authentication Unit
AU-102 Biometric Authentication	Finger Vein Scanner
WT-515 Working Table	Authentication Device Placement



- All specifications refer to A4-size paper of 80 GSM quality.
- The support and availability of the listed specifications and functionalities vary depending on operating systems, applications and network protocols as well as network and system configurations.
- Some of the product illustrations contain optional accessories.
- Specifications and accessories are based on the information available at the time of printing and are subject to change without notice.
- Konica Minolta does not warrant that any specifications mentioned will be error-free.
- All brand and product names may be registered trademarks or trademarks of their respective holders and are hereby acknowledged.

For more information please visit the bizhub Website at
<http://bt.konicaminolta.in/bizhub-c226-product-overview/>

KONICA MINOLTA, the KONICA MINOLTA logo and symbol mark, "Giving Shape to Ideas", bizhub, bizhub PRO, bizhub PRESS, magicolor, PagePro, PageScope, Simitri, Simitri HD, Simitri HD+, Simitri with Biomass, Emperon, S.E.A.D., S.E.A.D.II, Printgroove and Konica Minolta Optimised Print Services and their respective logos are registered trademarks or trademarks of KONICA MINOLTA, INC. Evernote is a registered trademark or trademark of Evernote Corporation. SharePoint is a registered trademark or trademark of Microsoft Corporation in the U.S. and other countries. All other brands and product names are registered trademarks or trademarks of their respective companies or organisations.

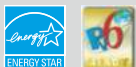

Ecology & Environment

KONICA MINOLTA products are designed with the environment in mind.

- Energy Star
- RoHS Compliance
- WEEE Compliance
- Eco-friendly Toners



REQUIREMENTS FOR SAFE USE

- Please read and follow the instruction manual to ensure safe operation.
- Only operate using appropriate power supply and voltage.
- Connecting the earth wire to an inappropriate place may cause explosion or electric shock. Please connect accordingly.

For more information: SMS "KM OFFICE" send to 52424 or Call: 1-800-266-2525
Konica Minolta Business Solutions India Pvt. Ltd. : 10th Floor, Building No.8, Tower C,
DLF Cyber City, Phase II Gurgaon, Haryana - 122002, India. Board No. +91-124 6652000.
URL: www.konicaminolta.in, marcom@bin.konicaminolta.in | Konica Minolta Inc., Tokyo, Japan.

Connect with us :

Contact Point:

